

August, 2024

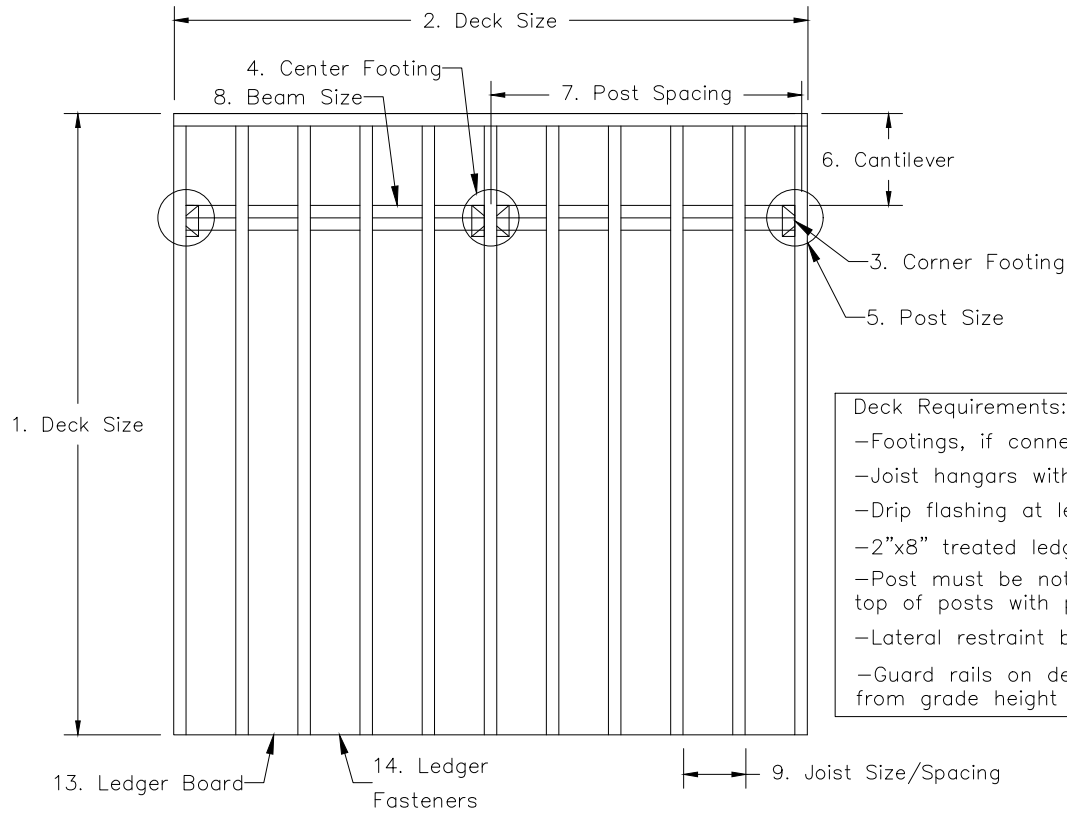

Deck Requirements:

- Footings, if connected to dwelling
- Joist hangers with proper fasteners
- Drip flashing at ledger
- 2"x8" treated ledger board
- Post must be notched or sitting on top of posts with proper connections
- Lateral restraint blocks
- Guard rails on decks above 30" from grade height

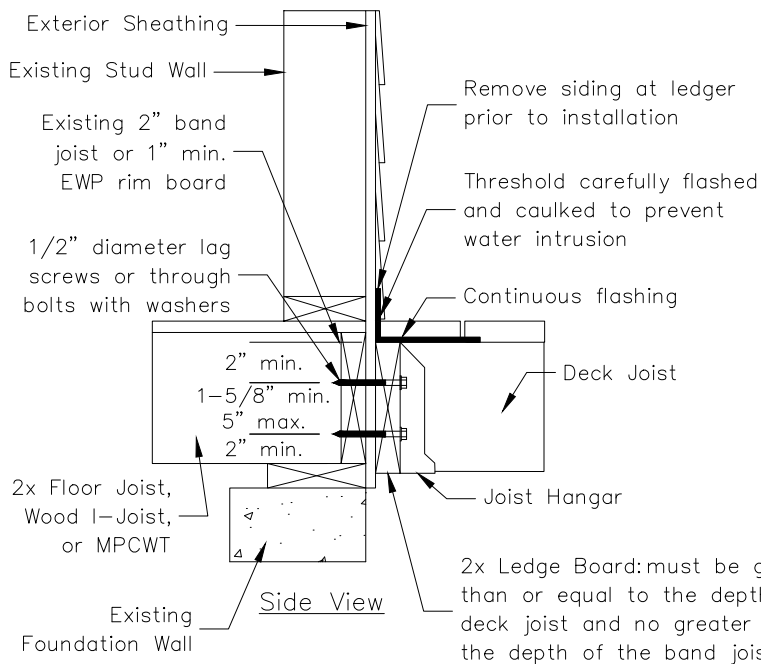

- Deck Size (joist Length): _____ ft
- Deck Size (width): _____ ft
- Corner Footings (diameter): _____ in
- Center Footings (diameter): _____ in
- Post Size (4x4, 6x6): _____
- Cantilever: _____ (if applicable)
- Post Spacing: _____ ft.
- Beam Size: _____ PLY 2X _____
- Joist Size/Spacing: 2X _____" O.C.
- Material (Trtd., Cedar, Composite)
- Height Above Grade: _____
- Decking Size (5/4 x 5.5): _____
- Ledger Board (2x8" Treated): _____
- Ledger Fasteners: 1/2" x _____
- Fastener Size: 1/2" x _____ (Galvanized)

August, 2024



CITY OF WATERTOWN PUBLIC WORKS DEPARTMENT COMMUNITY DEVELOPMENT DECK PLAN

SHEET
2
OF
3

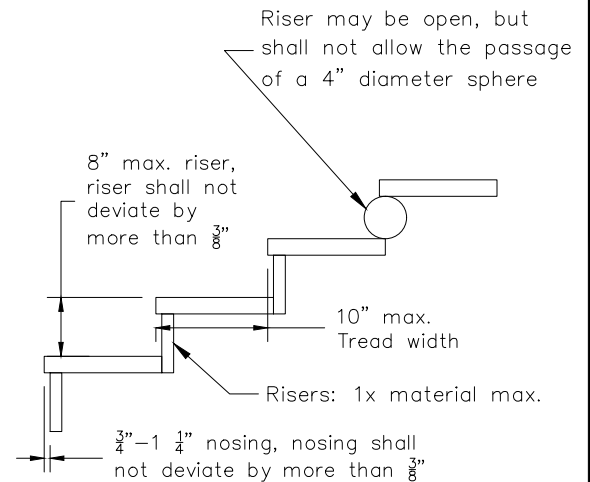
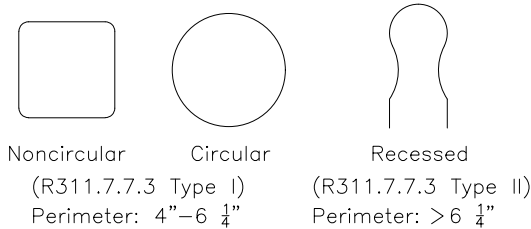
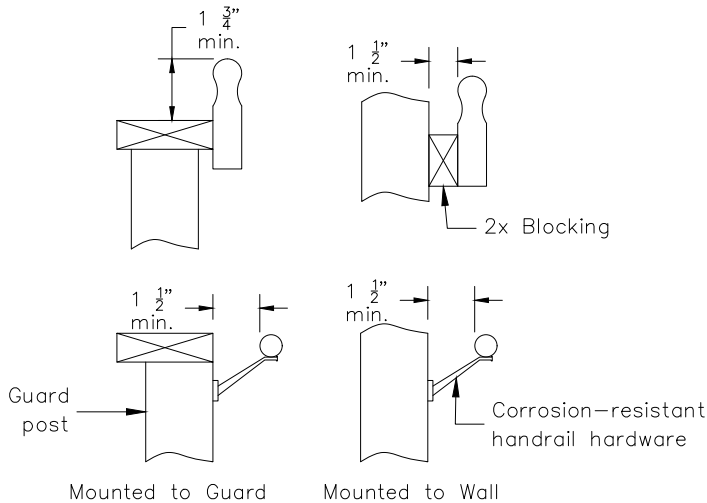

Handrails:
Shall be continuous for the full length of the flight, from a point directly above the top riser of the flight to a point directly above the lowest riser of the flight. Handrail ends shall be returned or shall terminate in newel posts or safety terminals.

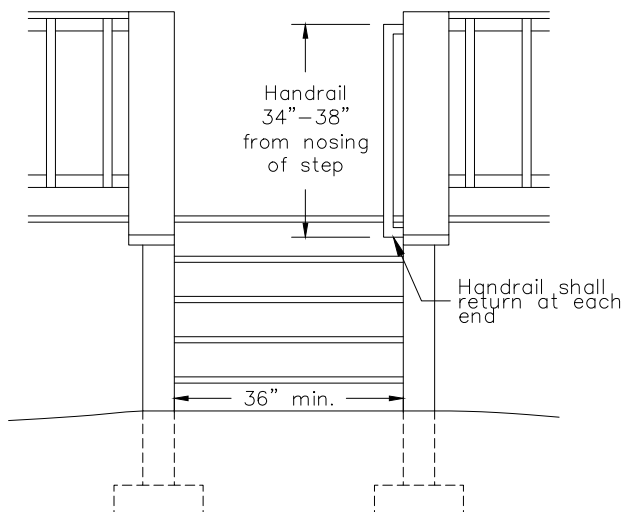

Landings for Stairways:
There shall be a floor or landing at the top and bottom of each stairway. The width perpendicular to the direction of travel shall be not less than the width of the flight served. For landings of shapes other than square or rectangular, the depth at the walk line and the total area shall be not less than that of a quarter circle with a radius equal to the required landing width. Where the stairway has a straight run, the depth in the direction of travel shall be not less than 36"

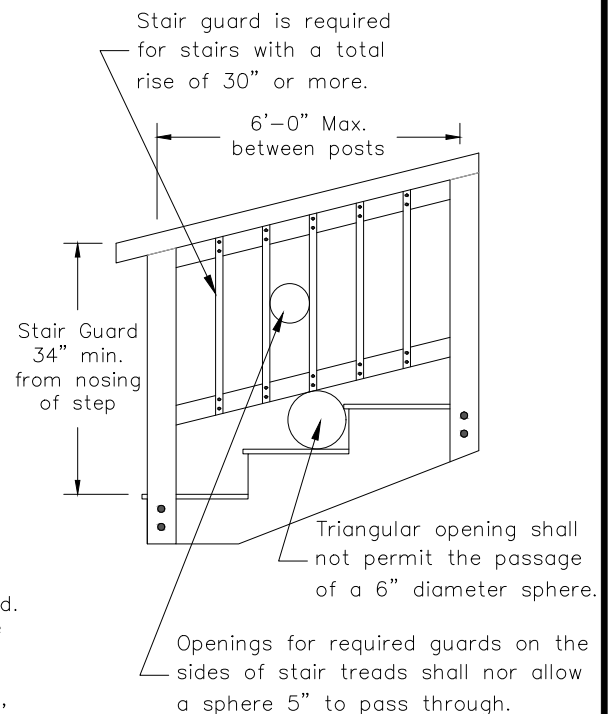

August, 2024